



**Effra Parade, Brixton, SW2**

3 bedroom flat to let

**£646 Per Week**

Furnished

## Property Details

This wonderful three double bedroom apartment forms part of a recently built apartment block conveniently located within walking distance to both Brixton and Herne Hill town centers. The apartment offers three double bedrooms and a spacious, contemporary open plan kitchen and reception, and to top this beautiful property off you'll have a bright and modern family sized bathroom. Living here you'll be around a five minute walk from Brockwell Park and you'll be around a ten minute walk from Herne Hill station.

## Features

- Three double bedrooms
- Family bathroom
- Open plan reception
- Five minutes to Brockwell park
- Excellent transport links
- Modern new build apartment
- Close to Central Brixton

Council tax band D    EPC rating B (81)





## Effra Parade

# K

### 3 Bed Flat

Approx internal area:

722 sqft 67 sqm

While we do try our very best, floor plans are produced as a guide only and we take no responsibility for the precise accuracy with which any property is represented

Second Floor

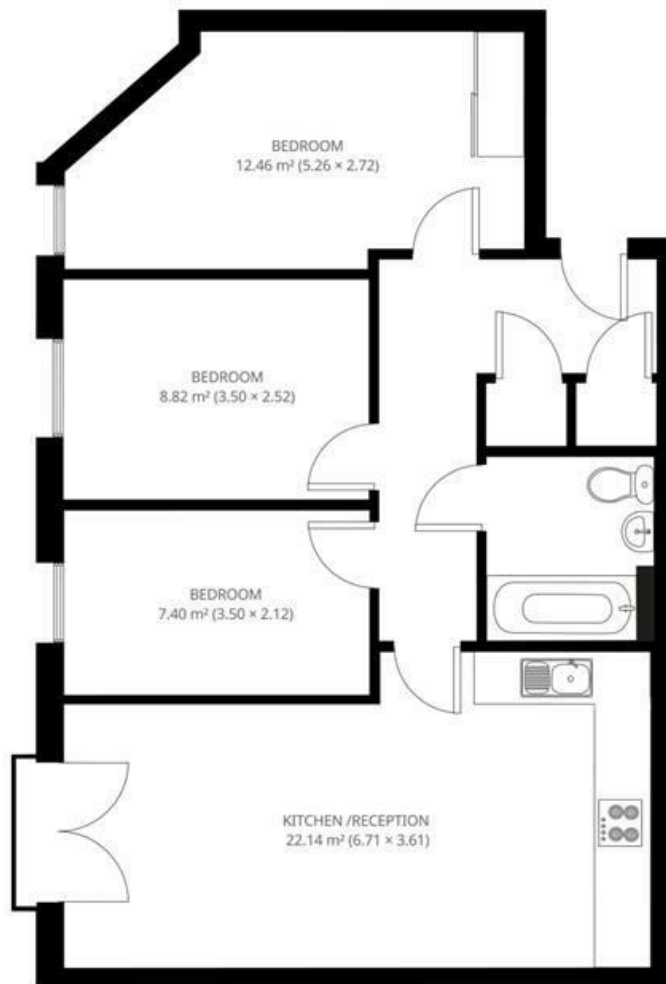

Effra Parade, Brixton, SW2

