



Lambert Road, Brixton, SW2

1 bedroom flat to let

£380 Per Week

Furnished

Property Details

A gorgeous one double bedroom garden flat which is a stones throw away from central Brixton and only a short walk away from Clapham Common. This flat comprises of a wonderfully bright open-plan reception room and kitchen area with doors out to the garden to the rear as well as a spacious double bedroom to the front. The patio garden is South facing and easy to maintain.

Features

- Victorian
- South facing private garden
- One double bedroom
- Open plan reception and kitchen area
- Located a short walk from Central Brixton

Council tax band C EPC rating E (49)



Lambert Road, SW2

Approximate Gross Internal Area
52.5 sq m / 565 sq ft

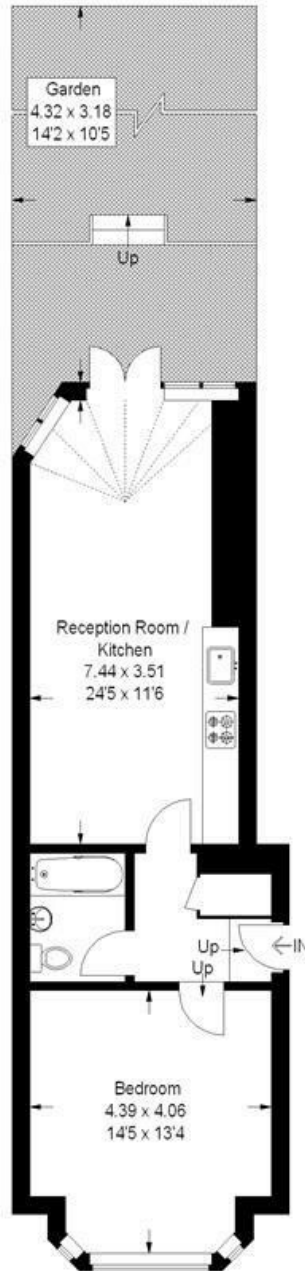

Ground Floor

This plan is for layout guidance only. Not drawn to scale unless stated. Windows and door openings are approximate. Whilst every care is taken in the preparation of this plan, please check all dimensions, shapes and compass bearings before making any decisions reliant upon them. (ID176400)

Lambert Road, Brixton, SW2

