



Brailsford Road, Brixton, SW2

2 bedroom flat - conversion for sale

£500,000

Share of Freehold

Property Details

An attractive two double bedroom flat for sale overlooking Brockwell Park from a Victorian conversion. Leafy and quiet, Brailsford Road is a sought-after street with gates onto Brockwell Park just a ten-minute walk to Brixton and fifteen-minutes to Herne Hill. A spacious reception room runs the width of the property flooded with natural light from wooden sash windows, a bright and airy room with space to both lounge and dine at a large table. The separate dine-in kitchen is set to the rear relishing views over Brockwell Park with sleek white cabinets and generous work surfaces plus breakfast bar. Enjoying the same leafy views, the principal bedroom is a spacious room currently being utilised as a home office, with high corniced ceilings and sash windows this room can be repurposed back to a large bedroom. Still a genuine double, the second bedroom sits across the hall, providing privacy to both bedrooms ideal for sharers. A neutral family bathroom completes the home, equipped with shower and bath tub. The flat is fully double glazed, the exterior was refurbished in the last two years and internal hallways updated, the new purchaser will also have access to a shared cellar space.

Features

- Two double bedrooms
- Victorian conversion
- Views over Brockwell Park with entrance on the road
- Highly sought-after residential road
- Separate kitchen and reception room
- Bright and airy throughout
- Brixton a ten-minute stroll
- Herne Hill a fifteen-minute walk
- Share of freehold
- Chain-free

Council tax band C EPC rating C (70)



Brailsford Road, Brixton, SW2

Brailsford Road, SW2

2 Bedroom Flat

APPROXIMATE TOTAL INTERNAL AREA: 599 SQ FT / 55.5 SQ M

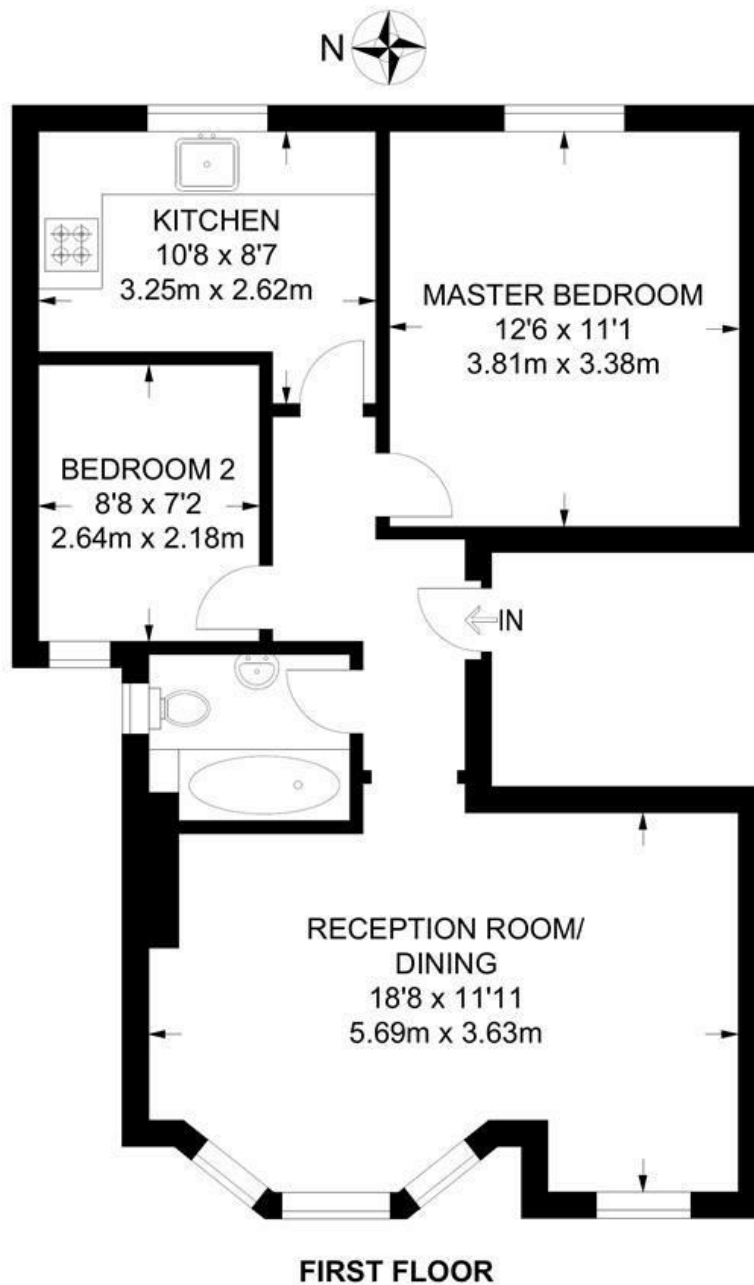

While we try our very best, floor plans are produced as a guide only and we take no responsibility for the precise accuracy with which any property is represented.

Brailsford Road, Brixton, SW2

