



Ducie Street, Clapham North, SW4

2 bedroom flat to let

£460 Per Week

Part furnished

Property Details

This is a really lovely two bedroom conversion flat in a charming Victorian building. To the front of the property are the two double bedrooms which are both of decent size, and the clean and modern shared bathroom. The second bedroom has a door opening out onto a small private courtyard. Along the hallway to the rear is the open plan kitchen and reception room which is large and airy with skylights letting in natural light. Double doors lead out to the private courtyard garden. Ducie Street is in a great location, with Brixton underground and Clapham North underground station both only a seven minute walk away. Brixton has plenty to offer, with Pop Brixton, the markets, and plenty of shops and restaurants only minutes away.

Features

- Two bedrooms
- Open Plan
- Private Garden
- Victorian conversion
- Bright and airy
- Close to Central Brixton
- Close to transport links

Council tax band D EPC rating D (65)



Ducie Street

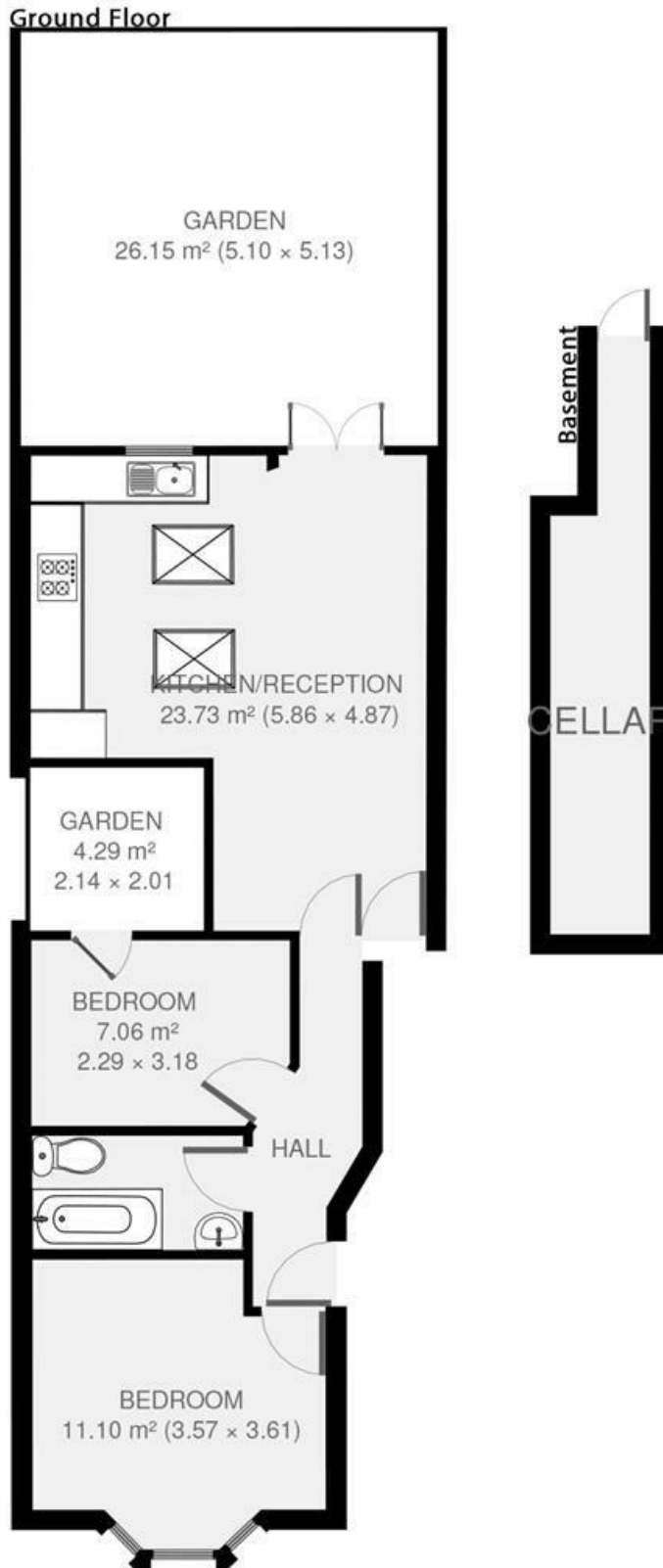

2 bed Flat.

Approx internal area:

614 sqft 57 sqm

While we do try our very best, floor plans are produced as a guide only and we take no responsibility for the precise accuracy with which any property is represented

Ducie Street, Clapham North, SW4

