



## Stockwell Gardens, SW9

2 bedroom flat - purpose built for sale

£420,000

Leasehold

### Property Details

Keating Estates are proud to present to market a spacious two double bedroom apartment set over the first floor of a purpose built property on Stockwell Gardens, with local shops and eateries on the doorstep, a three-minute walk to Stockwell Tube interchange for the Victoria and Northern Lines. This bright and versatile home is ready to move into with the potential to add your own mark over time. Forming the heart of the home the reception offers generous proportions in which to lounge and dine, a sizeable room with dual aspect windows. The separate kitchen provides generous storage within wood finished cabinetry, topped with black gloss surfaces. Both double bedrooms have large windows and are quietly tucked away from the sociable spaces, offering space for sizeable wardrobes plus further storage. The bathroom is equipped with both bath and shower, with an appealingly sized window creating a soothing ambience. The WC is separate, ideal for sharers with the potential to reconfigure to one large bathroom if preferred and subject to necessary permissions. Completing the interior, there are two storage cupboards in the spacious hallway.

### Features

- Two double bedrooms
- Purpose built property
- Separate reception and kitchen
- 840 square feet of internal space
- Bright and airy throughout
- Local amenities on the doorstep
- Victoria and Northern Lines a three-minute walk at Stockwell Tube
- Brixton and Clapham both around a fifteen-minute stroll away
- Chain-free

Council tax band B      EPC rating C (70)





Stockwell Gardens, SW9

**Stockwell Gardens, SW9**

**2 Bedroom Flat**

APPROXIMATE GROSS INTERNAL AREA: **840 SQ FT / 78 SQ M**

---

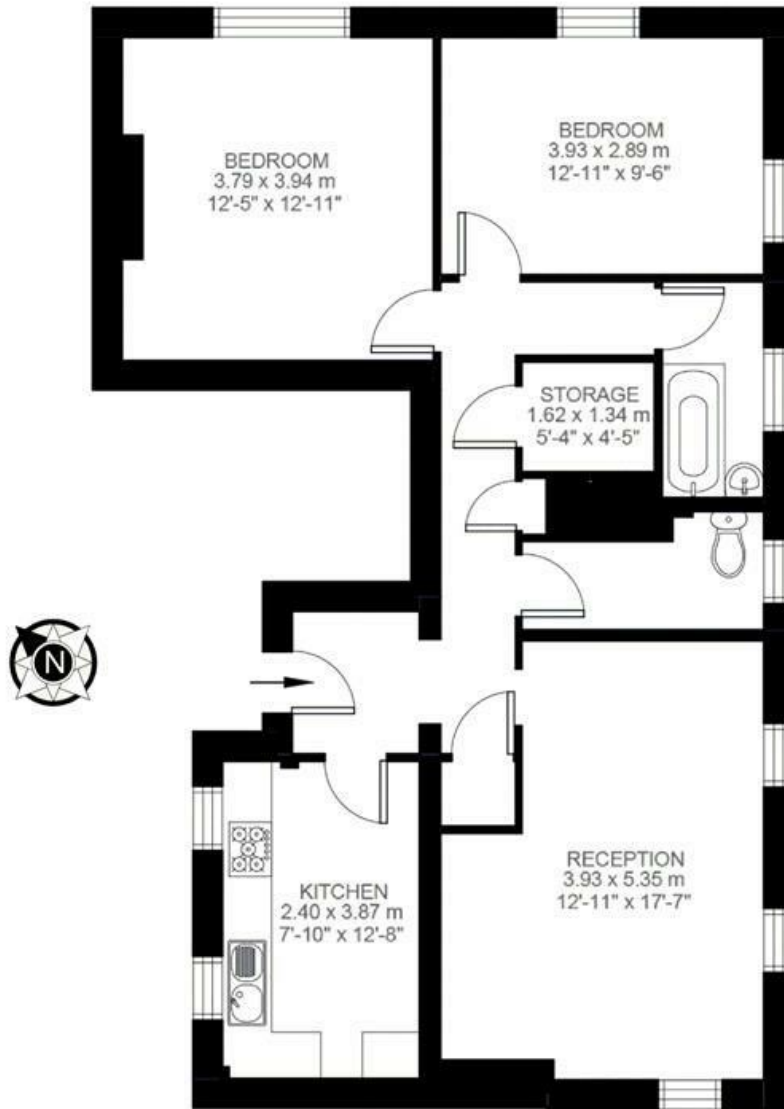

First Floor



While we try our very best, floor plans are produced as a guide only and we take no responsibility for the precise accuracy with which any property is represented.



Stockwell Gardens, SW9

