

Belvedere Place, Brixton, SW2

2 bedroom flat - purpose built for sale

£495,000

Leasehold

Property Details

A bright two bedroom, two bathroom flat with a Juliet balcony, gardens and a garage, within a sought-after, gated mews. One of the best in the development this apartment has multiple perks, set peacefully to the rear of the first building, on the top floor enjoying additional privacy and light, plus a large garage and fibre optic broadband. The open-plan living space has a cosy lounge area, space for a large dining table and a Juliet balcony. The contemporary separate kitchen is adjacent, with plenty of storage options, all the mod-cons and quartz surfaces. The principal bedroom has cosy carpets and built-in storage plus an en-suite with heated towel rail, rain shower and mirrored, lit cabinetry with in-built speaker and anti-steam function. The second bedroom is currently utilised as a nursery, easily repurposed to a guest room or office. The modern family sized bathroom has a bath and there is further storage in two cupboards in the hall. With access to two communal gardens, there is plenty of outside space for the summer months, plus bike storage by arrangement and an unrivalled location.

Features

- Two bedrooms
- Two bathrooms
- Juliet balcony plus access to two communal gardens
- Private garage
- Secure gated mews development
- Secure bike storage by arrangement
- Ample storage
- Central quiet location, close to the action
- Walking distance to Northern and Victoria lines

Council tax band D EPC rating C (76)





Belvedere Place, Brixton, SW2

Belvedere Place, SW2

2 Bedroom Flat

APPROXIMATE GROSS INTERNAL AREA WITH GARAGE: **879 SQ FT / 81.7 SQ M**

APPROXIMATE GROSS INTERNAL AREA WITHOUT GARAGE: **743 SQ FT / 69 SQ M**

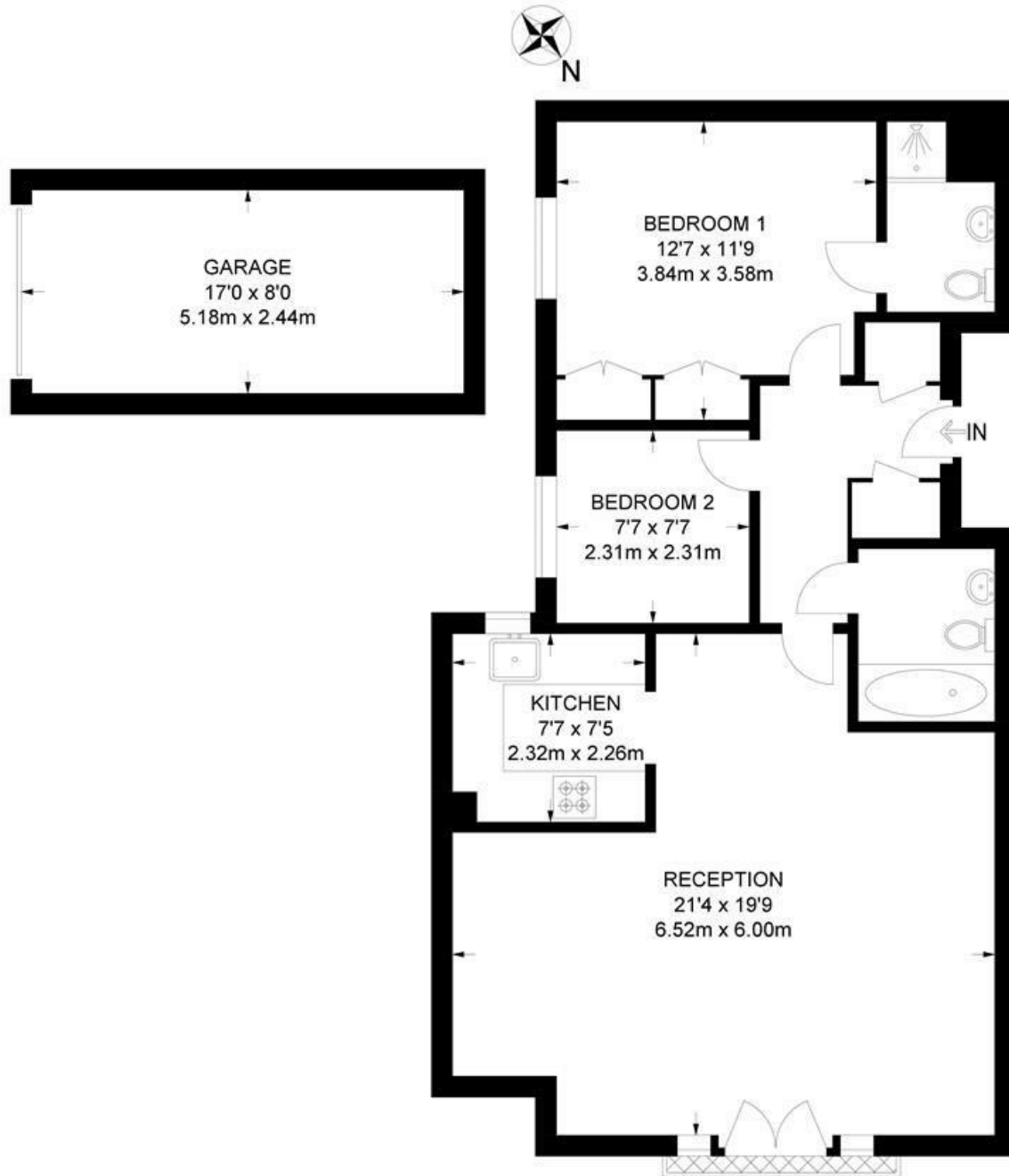

THIRD FLOOR



While we try our very best, floor plans are produced as a guide only and we take no responsibility for the precise accuracy with which any property is represented.

Belvedere Place, Brixton, SW2

