



Raeburn Street, Brixton, SW2

2 bedroom flat - conversion for sale

£610,000

Share of Freehold

Property Details

This two double bedroom split-level garden maisonette will appeal to a wide range of purchasers due to the appealing dimensions, fantastic condition and handsome setting within a converted Victorian end-of-terraced house on a quiet residential road, almost equidistant to both Clapham and Brixton centres. A charming eat-in kitchen, with country styling which opens out onto the lovely private outdoor space. This airy split-level home offers 770 square foot of internal space, including recently fitted and neutral family bathroom. A spacious reception room boasts high ceilings, original coricing and a beautiful bay window, making it the perfect space to unwind in front of the characterful fireplace. Original dividing doors separate the reception room from the principle bedroom, providing a generous space that can be repurposed to suit the needs of the purchaser. Downstairs leads to the second double bedroom, conveniently tucked away peacefully and complimented by a walk-in wardrobe or study room adjacent. Overall a well-located, spacious and characterful garden property offering a flexible layout, ideal for sharers, single occupants or couples.

Council tax band C EPC rating D (64)

Features

- Two double bedrooms
- Victorian conversion
- Private garden
- 770 square feet of internal living space
- Split-level
- Own front door
- Walk in wardrobe or study
- Share of freehold
- Short walk to both Clapham and Brixton
- Access to Victoria and Northern lines

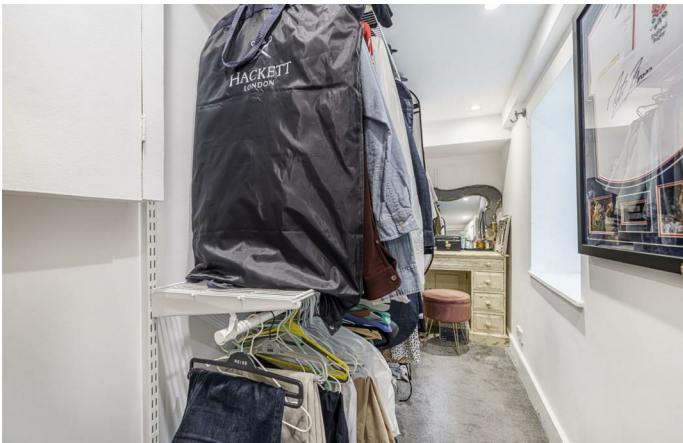

Raeburn Street, Brixton, SW2

Raeburn Street, SW2
2 Bedroom Flat

APPROXIMATE TOTAL INTERNAL AREA: 770 SQ FT / 71.5 SQ M

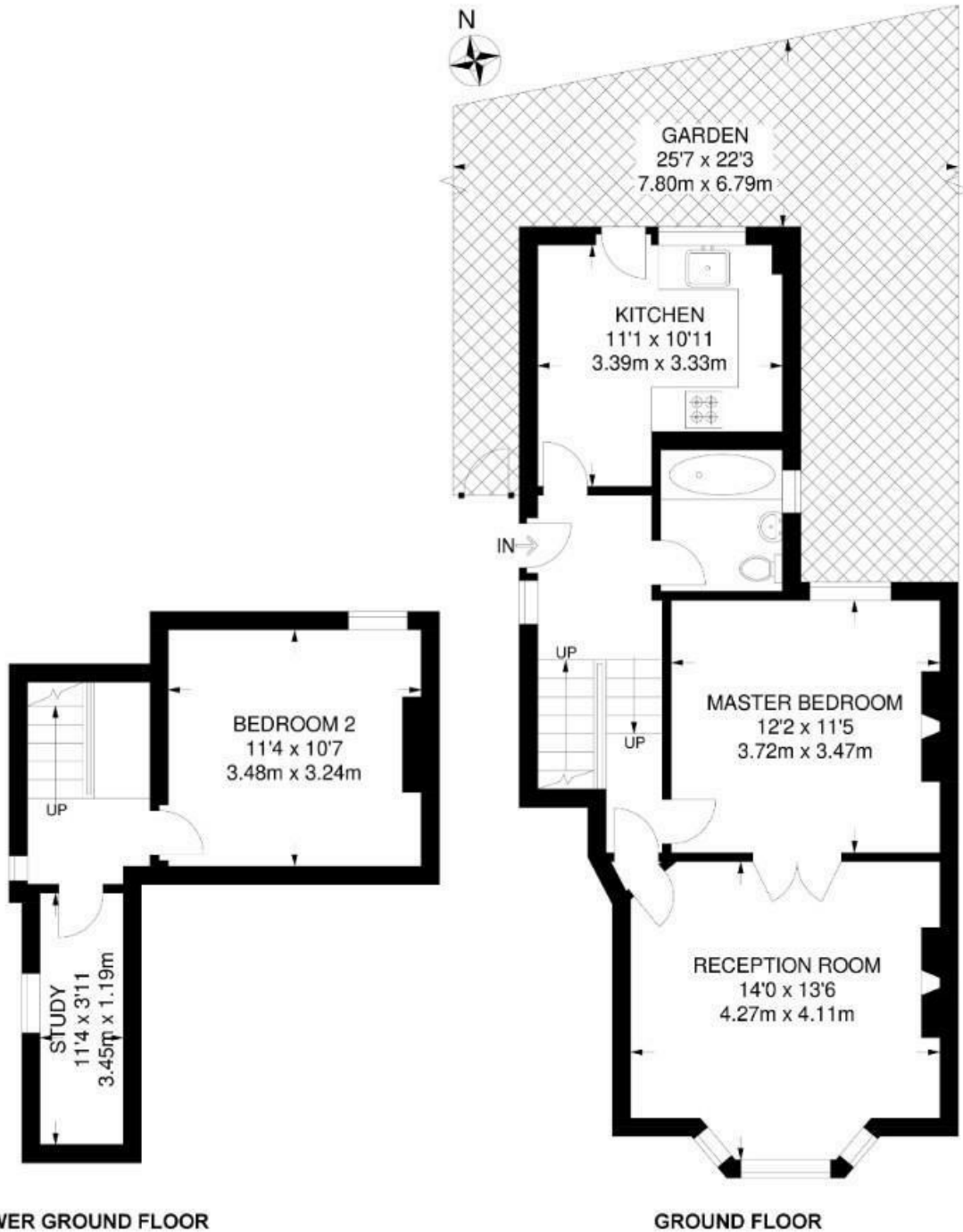

While we try our very best, floor plans are produced as a guide only and we take no responsibility for the precise accuracy with which any property is represented.

Raeburn Street, Brixton, SW2

