



Acre Lane, Brixton, SW2

4 bedroom maisonette for sale

£625,000

Leasehold

Property Details

A bright four double bedroom maisonette, split over the upper floors of a Victorian end of terrace, on the up-and-coming Acre Lane. With a private entrance this spacious and versatile home has additional light and privacy due to the elevation. The generous reception room is has multiple sash windows with high, corniced ceilings, perfect for unwinding on the sofa or hosting dinner at the table. The separate kitchen has sleek grey cabinets, maximising storage and creating a pleasant space to cook. Split over the two floors are three generously proportioned double bedrooms and a forth smaller room. This is a versatile room which could become a home office. Boasting high ceilings the bedrooms are neutrally presented in soothing tones. Two of the three large bedrooms are set to the rear with views across the rooftops whilst the third is elevated above the street with dual-aspect windows. There are bathrooms on both floors, the family bathroom is equipped with storage, heated towel rail and a bathtub with overhead shower. A separate WC is adjacent, ideal for sharers or guests. A shower room sits on the upper floor, with further storage.

Council tax band D EPC rating D (57)

Features

- Four bedrooms
- Victorian end of terrace maisonette
- 974 square feet
- Split over two floors
- Bright and airy
- Private entrance
- Local amenities of Acre Lane on the doorstep
- Central Brixton and Clapham High-street both a ten-minute stroll
- Victoria and Northern tube lines in minutes
- Chain-free



Acre Lane, Brixton, SW2

Acre Lane, SW2
4 Bedroom Flat

APPROXIMATE GROSS INTERNAL AREA: **974 SQ FT / 90.5 SQ M**

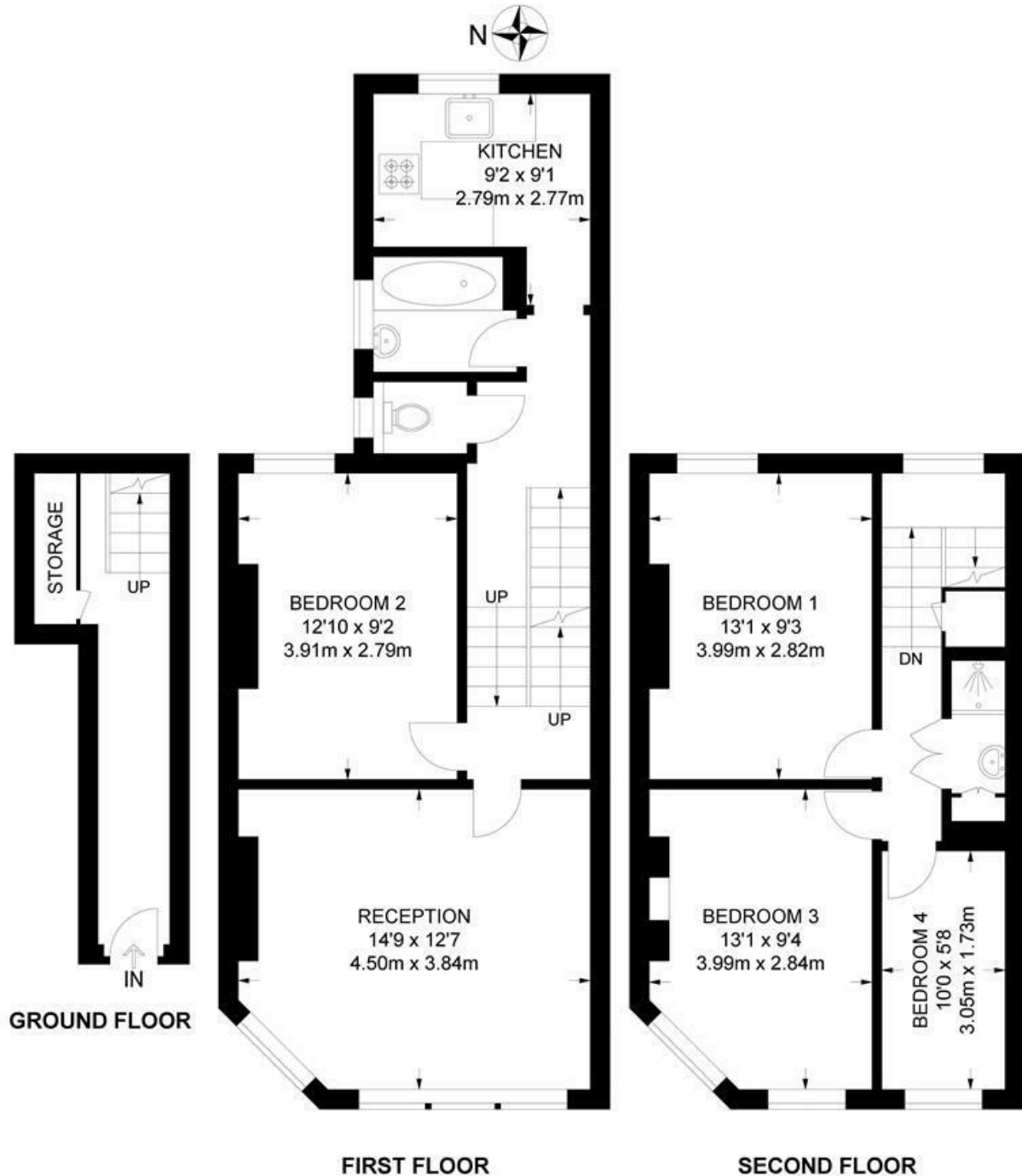

While we try our very best, floor plans are produced as a guide only and we take no responsibility for the precise accuracy with which any property is represented.

Acre Lane, Brixton, SW2

