



Clapham Road, Clapham, SW9

2 bedroom flat - purpose built for sale

£650,000

Leasehold

Property Details

A two double bedroom apartment with private terrace within a secure, modern building in a convenient location with Clapham North tube, Clapham High Street and a supermarket on the doorstep. Designed with modern living in mind, this energy efficient open-plan property offers air con as well as heating, over 700 square feet of airy living space and high-quality fixtures throughout. The bright, spacious open-plan reception has multiple floor-to-ceiling windows, French doors to the terrace and a large skylight with a cosy living area, room for dining and a sleek integrated kitchen. The private terrace is low maintenance, ready to enjoy come day or night, be it al-fresco hosting or soaking up the sun's rays. Both bedrooms are generous doubles, providing ample space for the traditional bedroom furnishings, one with wardrobes already fitted. A luxurious bathroom is equipped with a shower over the bathtub. There are two storage cupboards in the hallway plus further communal storage in the building for bikes and other items. The washing machine and tumble dryer will remain.

Features

- Two double bedrooms
- Private terrace
- Secure modern building
- Air conditioning as well as heating
- Unrivalled convenient location for transport links
- Moments to Clapham North tube
- Clapham High Street on the doorstep
- Brixton and Stockwell within walking distance
- Chain-free

Council tax band D EPC rating B (84)





Clapham Road, Clapham, SW9

Clapham Road, SW9
2 Bedroom Flat

APPROXIMATE GROSS INTERNAL AREA: **712 SQ FT / 66 SQ M**

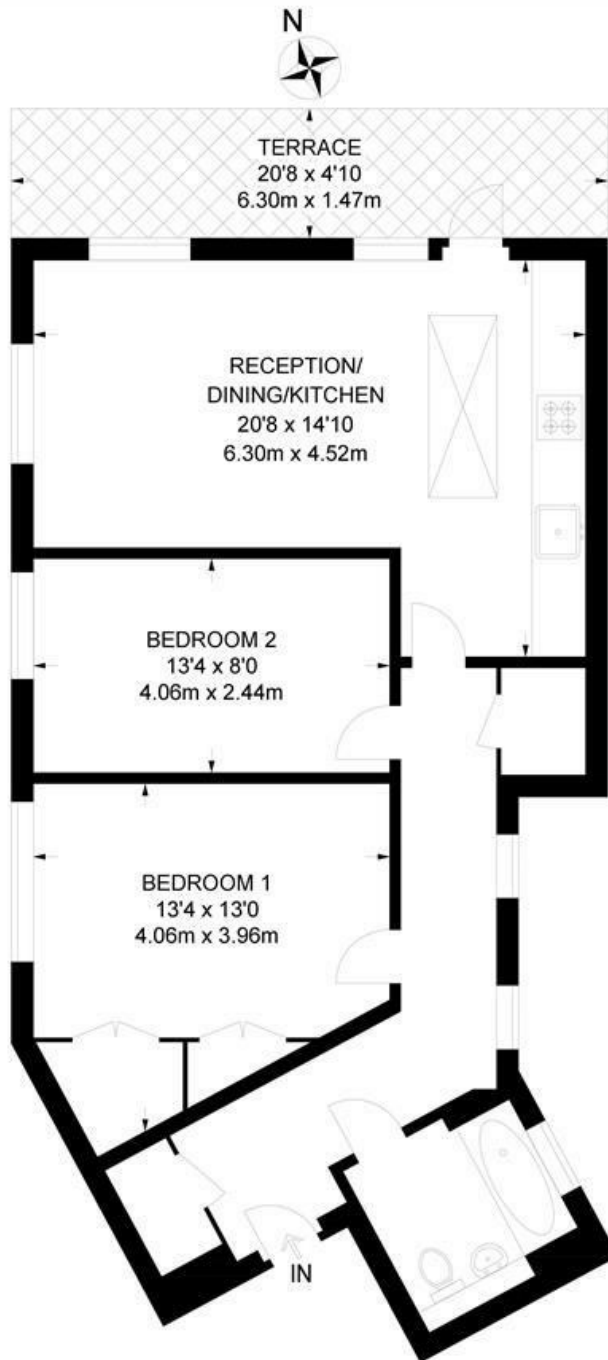

SECOND FLOOR



While we try our very best, floor plans are produced as a guide only and we take no responsibility for the precise accuracy with which any property is represented.

Clapham Road, Clapham, SW9

