



Coldharbour Lane, Brixton, SW9

1 bedroom flat - purpose built for sale

£390,000

Leasehold

Property Details

An appealing one double bedroom flat within a prevalent Victorian Mansion block in the heart of Brixton. This secure apartment is perfect for anyone who wants to have the wide range of Brixton's amenities within close proximity but would like to remain tucked away quietly. In the well-proportioned reception room, a large bay window floods the space with natural, providing the perfect dining nook. Adjacent, the separate kitchen offers a sense of countryside chic, with wooden worktops and shaker style cabinetry. The spacious double bedroom is a soothing space, also enjoying a large bay window, with the proportions to accommodate a desk should working from home be required. Characterful wooden flooring adds to the ambience. Completing the internal is a modern bathroom, with a bathtub plus overhead shower. The icing on the cake is the sizeable communal roof terrace offering 360 degree views across Brixton and to the City beyond. Recently refurbished, this exceptional sun trap brings a wholesome sense of community to the building.

Features

- One double bedroom
- Large communal roof terrace with 360 degree views
- Victorian mansion block
- Quietly positioned in the building, away from the street
- Secure communal bike storage
- Central location in the heart of Brixton
- Start of the Victoria Line less than a five-minute walk
- Brockwell Park a fifteen-minute stroll

Council tax band C EPC rating D (59)





Coldharbour Lane, Brixton, SW9

Coldharbour Lane, SW9
1 Bedroom Flat

APPROXIMATE GROSS INTERNAL AREA: **440 SQ FT / 41 SQ M**

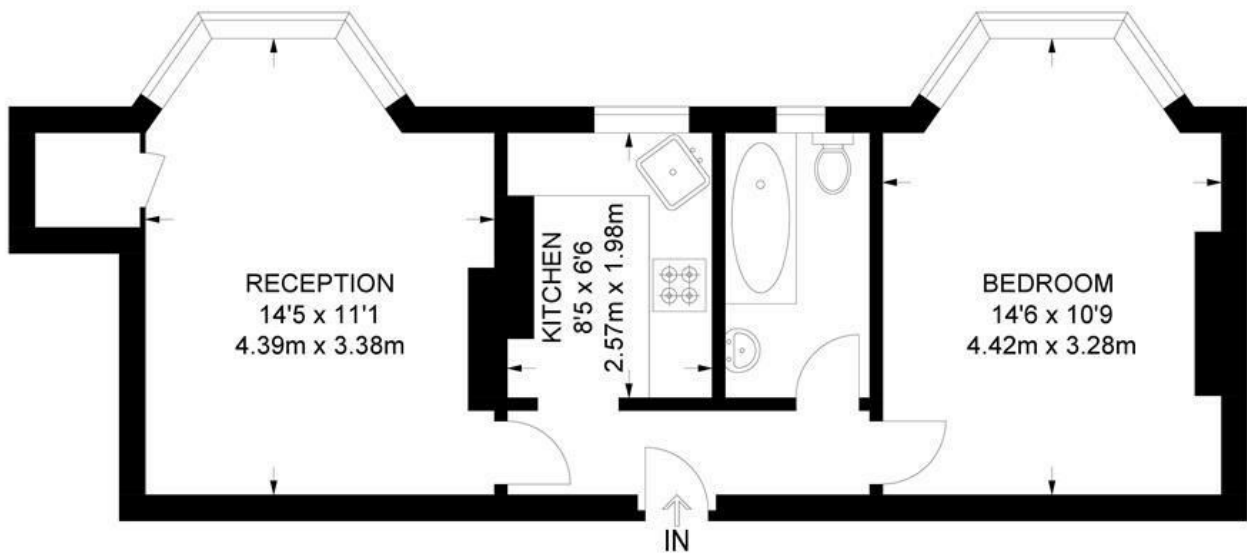

GROUND FLOOR



While we try our very best, floor plans are produced as a guide only and we take no responsibility for the precise accuracy with which any property is represented.

Coldharbour Lane, Brixton, SW9

