



Bicycle Mews, Clapham, SW4

2 bedroom flat - purpose built for sale

£575,000

Leasehold

Property Details

A two bedroom modern Penthouse with private terrace in an enviable location in central Clapham. Refurbished with wooden flooring, new bathroom and white goods plus decorative upgrade. Bright, quiet and private due to the top floor setting, high energy efficiency and sunny aspect. The sizeable open plan reception has space for a dining table and comfortable lounge. A modern kitchen has ample storage and new appliances. Floor to ceiling windows and door open to the sunny terrace with panoramic views ideal for hosting. Both bedrooms are doubles, the principal is particularly large with fitted wardrobes. The new bathroom has a walk-in rain shower plus storage and heated towel rail. With high energy efficiency and the recent upgrades this penthouse will be a great home. Further benefits of the development include secure entry system, bike storage and a lift.

Council tax band E EPC rating B (81)

Features

- Two double bedrooms
- Private South-East facing terrace with panoramic views
- Secure modern Penthouse
- Recently refurbished
- Vast array of bars, cafes and eateries on the doorstep
- Moments from the Northern Line and Overground
- Close to Clapham Common
- Chain-free



Bicycle Mews, Clapham, SW4

Bicycle Mews, SW4
2 Bedroom Flat

APPROXIMATE GROSS INTERNAL AREA: **652 SQ FT / 60.6 SQ M**

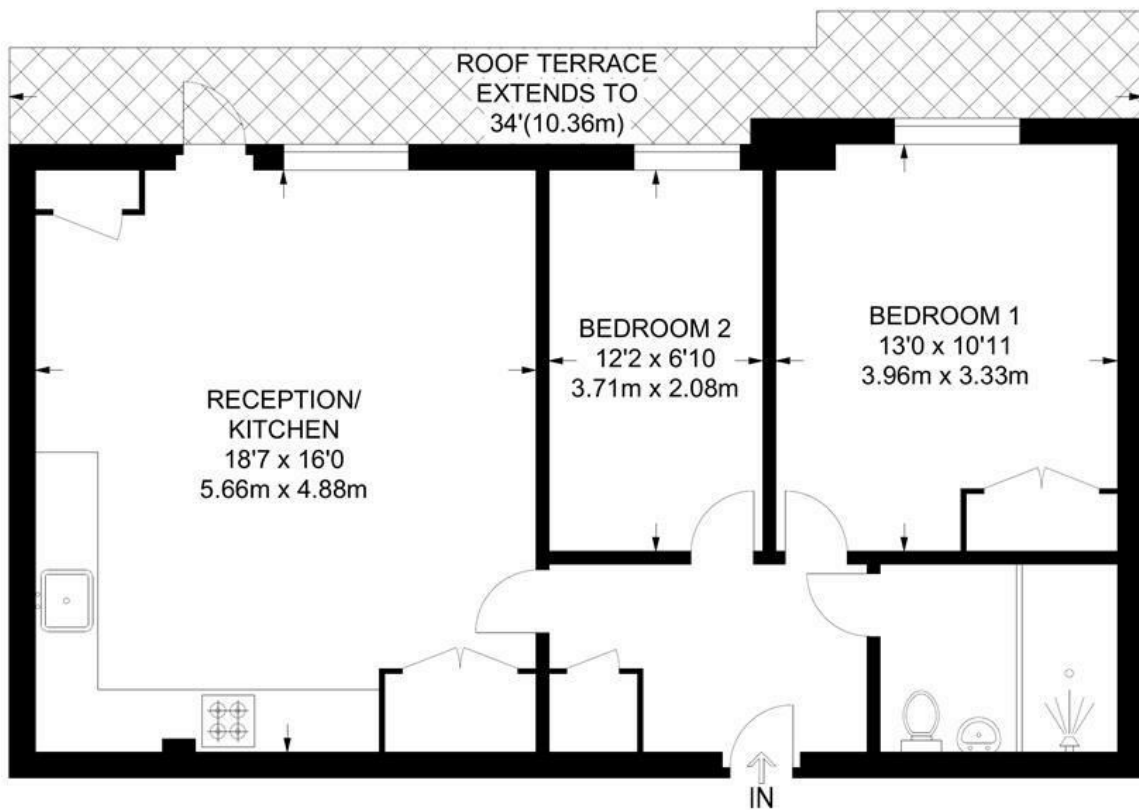

FIFTH FLOOR



While we try our very best, floor plans are produced as a guide only and we take no responsibility for the precise accuracy with which any property is represented.

Bicycle Mews, Clapham, SW4

