



**Sandmere Road, Clapham, SW4**

2 bedroom flat to let

**£450 Per Week**

Furnished

## Property Details

This is a great flat with two good sized double bedrooms and a lovely large bathroom. The living area is very large with a galley kitchen. Along with a spacious living area with large windows allowing lots of light into the property to give a bright and airy feel. The street is a quiet residential street between Clapham North and Brixton, being a five minute walk from Clapham North and the Northern Line and an eight or nine minute walk to Brixton with its train and Victoria Line connections.

## Features

- Two bedroom
- One bathroom
- Galley bedroom
- Bright and airy throughout
- Excellent transport links
- Victorian conversion

Council tax band C      EPC rating D (64)



Sandmere Road, Clapham, SW4

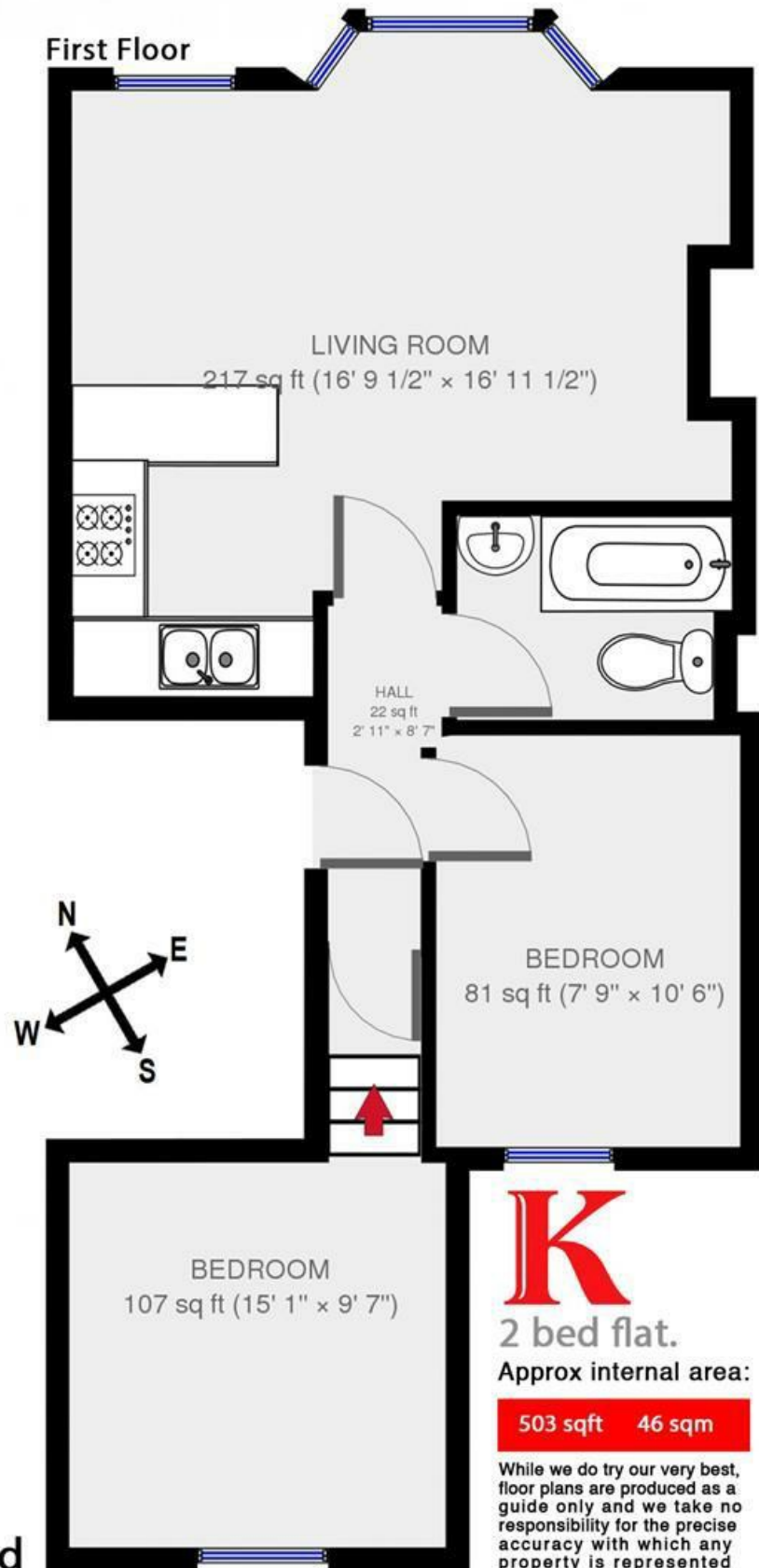

Sandmere Road

Sandmere Road, Clapham, SW4

