



Half Moon Lane, Herne Hill, SE24

2 bedroom flat to let

£461 Per Week

Part furnished

Property Details

A charming two double bedroom flat located in walking distance for the wonderful greenery of Brockwell Park. This flat comprises two spacious double bedrooms, a bright and airy open plan reception room, a modern kitchen and bathroom. The flat is only a short walk to three different train stations linking you to London Bridge in under 15 Minutes. The Saturday Market in Herne Hill is a 5-minute walk away and you will find many pubs and restaurants dotted along the route to Brixton, where you will never run out of evening entertainment, shows, and shopping as well as a culinary mecca of cuisines from around the globe.

Features

- Two Double Bedrooms
- Open Plan Reception
- Close to Brockwell Park
- Bright and Airy Throughout
- Close to Transport Links

Council tax band D EPC rating E (40)



Half Moon Lane, Herne Hill, SE24

Halfmoon Lane, Herne Hill, SE24

2 Bedroom Flat

Approximate internal area: **608 sqft 57 sqm**

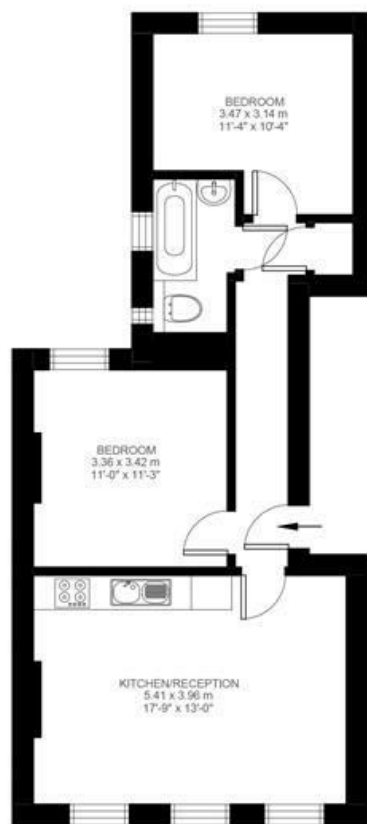

First Floor



While we do try our very best, floor plans are produced as a guide only and we take no responsibility for the precise accuracy with which any property is represented.

Half Moon Lane, Herne Hill, SE24

