

Brixton Hill, Brixton, SW2

£275,000

1 bedroom flat - purpose built for sale

Property Details

This well-located, one double bedroom sits within secure gated grounds on the second floor of this ever-popular, Art Deco block, with access to a lift. The property comprises a spacious double bedroom, a recently refurbished bathroom, a galley kitchen and a wonderfully bright South-facing reception room. The property is perfectly located just off Brixton Hill, a fifteen-minute stroll to all that Brixton has to offer in terms of food and nightlife and a ten-minute stroll to the open spaces of Brockwell Park. A pleasant twenty-minute walk across the park brings you to Herne Hill station and the many pubs, cafes and restaurants of leafy Herne Hill. Purchasers will have the popular establishments on Brixton Hill within touching distance, including F Mondays, Stir Coffee, Pizza Brixton and the White Horse Pub. First stop on the Victoria Line at Brixton tube station is a short stroll and there are multiple buses running up and down Brixton Hill, whisking you to the tube within a few minutes and onto central London.

Features

- One double bedroom
- Secure gated development
- 1930's Art Deco design
- Bright and airy throughout

Council tax band

EPC rating C (71)



Brixton Hill

K

1 Bed flat

Approx internal area:

446 sqft 41 sqm

While we do try our very best, floor plans are produced as a guide only and we take no responsibility for the precise accuracy with which any property is represented

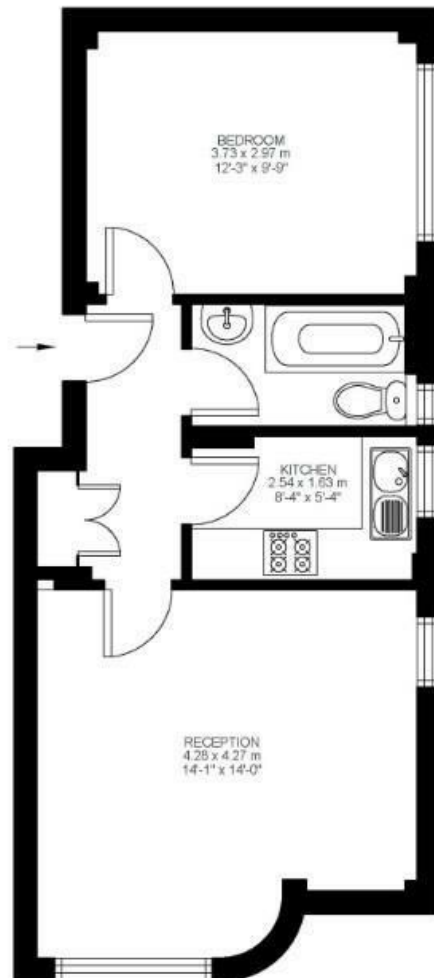

Second Floor



Brixton Hill, Brixton, SW2

