



**Ferndene Road, London, SE24**

6 bedroom house - detached for sale

**£1,300,000**

Freehold

## Property Details

A rare detached period six bedroom house on a lovely road overlooking Ruskin Park. The property is full of character with four reception rooms, a garage and a utility room. The property has a large front and rear garden and over 3000 square feet of living space. A staircase meanders up through the property to the first floor, where five large double bedrooms and two bathrooms are accessed from a large landing. Stairs lead up to a spacious loft room. Herne Hill station is a fifteen minute walk, Denmark Hill is a six minute walk and Loughborough Junction is a nine minute stroll.

## Features

- Private garden
- Characterful features
- Minor updating required
- Close to the park

Council tax band G      EPC rating (null)







Ferndene Road, London, SE24

## Ferndene Road

### First Floor



### Second Floor



### Ground Floor

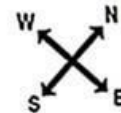
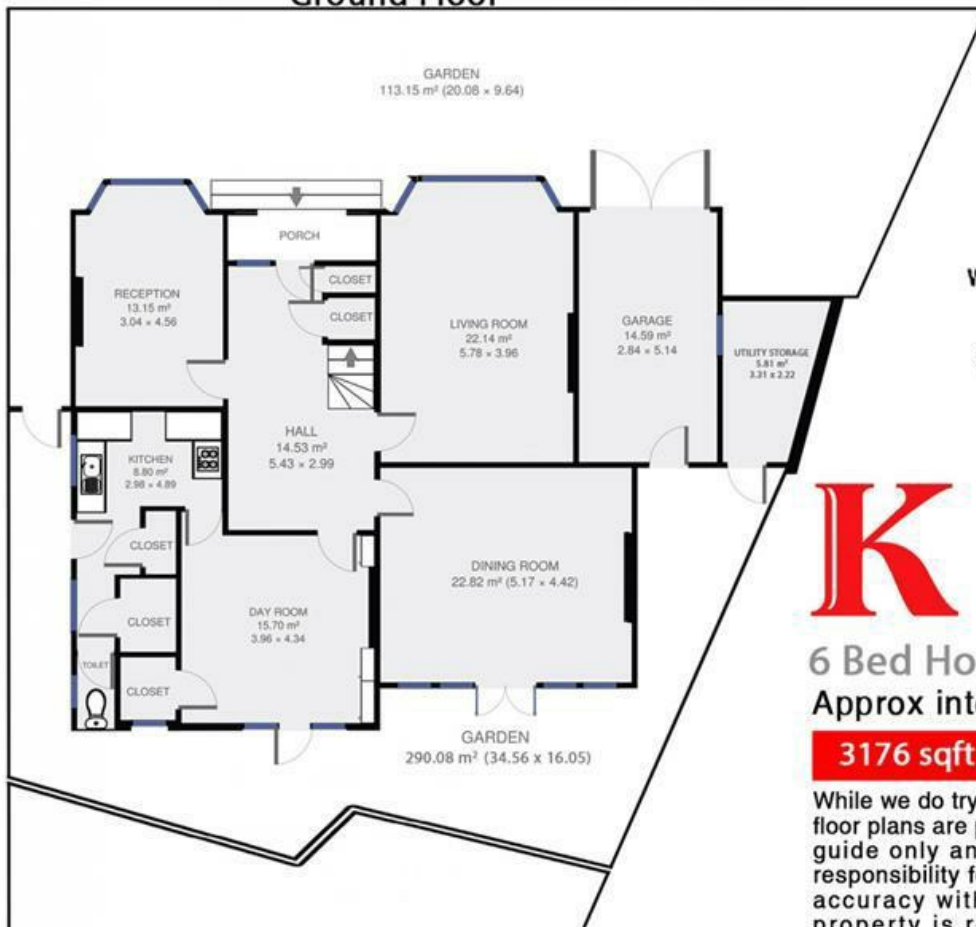

**6 Bed House.**  
**Approx internal area:**

**3176 sqft 295 sqm**

While we do try our very best, floor plans are produced as a guide only and we take no responsibility for the precise accuracy with which any property is represented

Ferndene Road, London, SE24

