



**Dulwich Road, Herne Hill, SE24**

**£325,000**

1 bedroom flat - purpose built for sale

## Property Details

A spacious and well-presented one bedroom flat located centrally in vibrant Herne Hill. This flat has a spacious living room and generously sized double bedroom, with a contemporary kitchen and bathroom. Situated directly opposite Brockwell Park, the green open spaces and the Lido pool are right on your doorstep. The local area offers shops, amenities and popular gastro pubs, and the ever popular Brixton is close-by.

## Features

- One double bedroom
- Secure modern development
- Bright and airy throughout
- Close to transport links
- Opposite Brockwell Park

Council tax band B    EPC rating D (66)



## Dulwich Road

# K

1 Bed flat

Approx internal area:

**414 sqft 38 sqm**

While we do try our very best, floor plans are produced as a guide only and we take no responsibility for the precise accuracy with which any property is represented

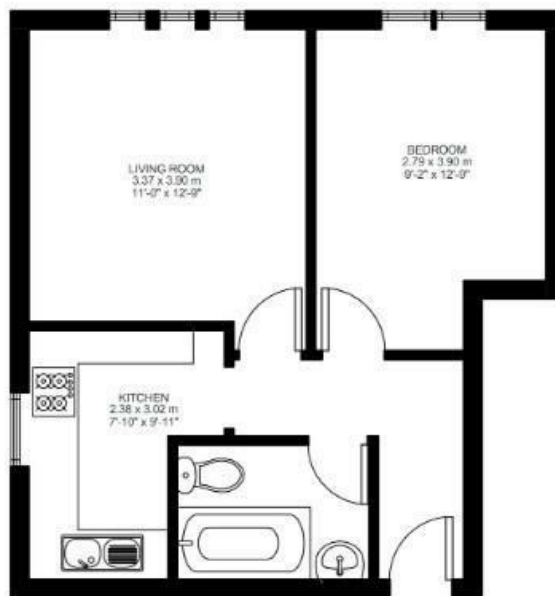

First Floor



Dulwich Road, Herne Hill, SE24

