

Norwood Road, Herne Hill, SE24

2 bedroom flat for sale

£350,000

Share of Freehold

Property Details

This lovely two bedroom flat is located in a great spot, being equidistant from both the wide open green space of Brockwell Park and convenient transport links from both Tulse Hill and Herne Hill stations. The property comprises a sleek and bright open plan kitchen and reception area, two bedrooms and a modern family bathroom. The flat also has access to a communal garden and shed which offers plenty of storage. The pubs and restaurants in Herne Hill, the Sunday market, and the station are all on your doorstep. In the other direction you have all the amenities on offer in Tulse Hill. The lauded Brixton Village, Brixton High Street and Brixton Station are all also within walking distance. Chain free.

Council tax band C EPC rating C (73)

Features

- Two double bedrooms
- Open plan reception and kitchen
- Bright and airy throughout
- Sought after location
- Close to Brockwell Park
- Close to transport links
- Share of freehold
- Chain free
- Large communal garden





Norwood Road

2 Bed Flat

Approx internal area:

539 sqft 50 sqm

While we do try our very best, floor plans are produced as a guide only and we take no responsibility for the precise accuracy with which any property is represented

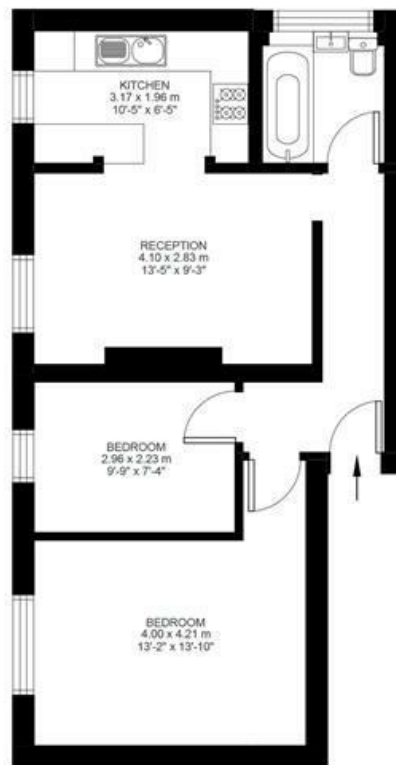

First Floor



Norwood Road, Herne Hill, SE24

