

Brailsford Road, Brixton, SW2

2 bedroom flat - conversion for sale

£485,000

Share of Freehold

Property Details

An exciting opportunity to purchase a nicely proportioned two double bedroom apartment, overlooking one of London's most popular parks. Brailsford Road is a quiet, Victorian terraced street which is a ten-minute walk to Brixton tube station and has an entrance to Brockwell Park actually on the road itself. The living space is fantastic, a bright and appealing open-plan room that provides comfortable dimensions for dining and relaxing, the country style kitchen with exposed wooden shelving is characterful, with plenty of storage and worktop space. The master bedroom is generous and the second is also a comfortable double and they both share lovely views overlooking the green open spaces of Brockwell Park. A contemporary bathroom with pretty tiling completes this lovely flat. The square footage is utilized thoughtfully, without wasting any space on dull and lifeless hallways. The property further comes with a share of the freehold, access to a large loft space and a share of the basement, ideal for storage.

Council tax band C EPC rating E (51)

Features

- Two double bedrooms
- Top floor Victorian conversion
- Highly sought-after residential road
- Views over Brockwell Park
- Access to large loft and cellar for storage
- Direct access to Brockwell Park
- Close to transport links
- 10 minute walk to Brixton
- Share of freehold





Brailsford Road, Brixton, SW2

Brailsford Road, Brixton, SW2

2 Bedroom Flat

Approximate internal area: **572 sqft 53 sqm**

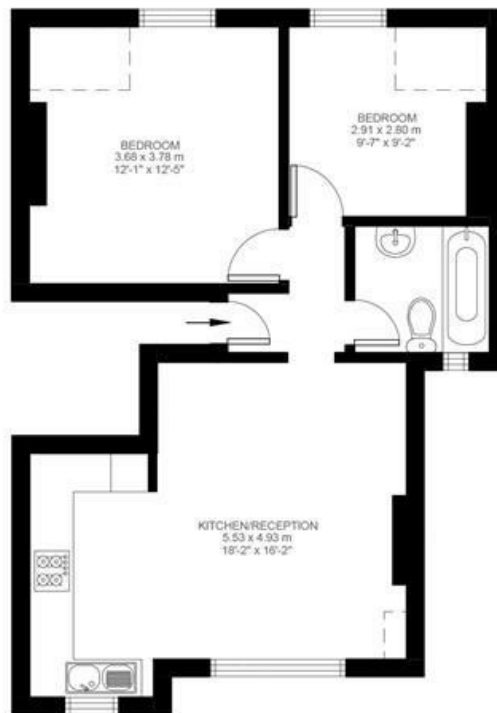

Third Floor



While we do try our very best, floor plans are produced as a guide only and we take no responsibility for the precise accuracy with which any property is represented.

Brailsford Road, Brixton, SW2

