



Larkhall Lane, London, SW4

£475,000

2 bedroom flat for sale

Property Details

A contemporary two double bedroom garden flat nestled securely on the ground floor of a converted period building on Larkhall Lane. The location is ideal, a short walk from the amenities within Clapham Old Town and Clapham High Street. Clapham Common and Battersea Park are also close-by. There are excellent transport links with Stockwell, Wandsworth Road, Clapham North and Clapham High Street stations all less than a ten-minute walk. This apartment comprises a spacious open plan reception, two comfortable double rooms, a modern bathroom and a private patio garden.

Features

- Private garden
- Victorian
- Close to the park
- Walking distance to the northern and victoria tube lines

Council tax band D EPC rating C (78)





Larkhall Lane

2 Bed flat

Approx internal area:

693 sqft 64 sqm

While we do try our very best, floor plans are produced as a guide only and we take no responsibility for the precise accuracy with which any property is represented

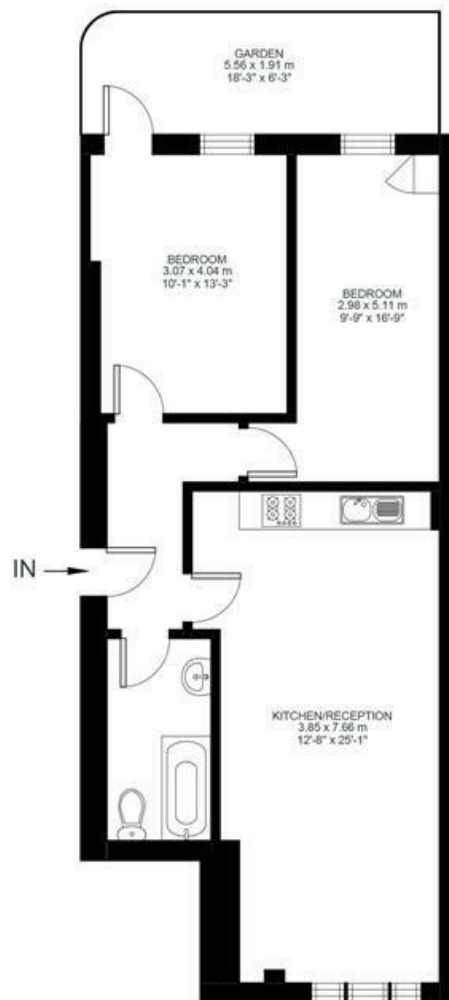

Ground Floor



Larkhall Lane, London, SW4

