



**Jelf Road, Brixton, SW2**

1 bedroom flat - conversion for sale

**£399,950**

Share of Freehold

## Property Details

A secure one double bedroom apartment nestled quietly at the top of this attractive Victorian converted house, ideally located between two in-demand residential areas; Brixton (5-minute walk) and Herne Hill (ten-minute walk). The bright staircase has views over the neighbouring rooftops and a false ceiling creates a fantastic storage area to keep all those items that are not used on a daily basis. The landing feeds a light and airy separate reception room which is neutrally presented with plenty of space to dine and attractive views of the neighbouring terrace row opposite. The bedroom is a spacious double room tucked away quietly at the back of the building with panoramic views out across the London skyline towards The Shard and beyond. Last but not least there is a well-appointed separate kitchen and a modern bathroom.

## Features

- One double bedroom
- Victorian top floor flat
- Bright and airy throughout
- Sought-after location
- Close to Brockwell Park
- Attractive views
- Share of freehold
- Chain Free

Council tax band B    EPC rating D (62)



Jelf Road, Brixton, SW2

Jeff Road, Brixton, SW2

1 Bedroom Flat

Approximate internal area: 505 sqft 47 sqm

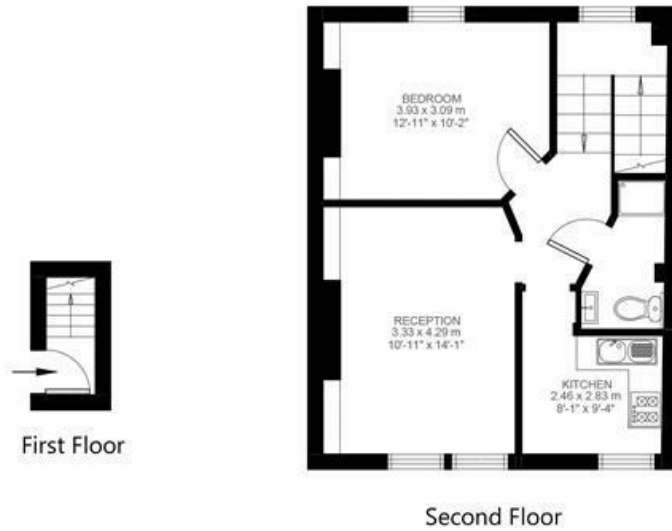

While we do try our very best, floor plans are produced as a guide only and we take no responsibility for the precise accuracy with which any property is represented.

Jelf Road, Brixton, SW2

