



Norwood Road, Herne Hill, SE24

1 bedroom flat - purpose built for sale

£370,000

Leasehold

Property Details

With close to 500 square feet of well-appointed space, the property feels comfortable and airy throughout. The spacious open-plan living area is ideal for entertaining or relaxing and unwinding, with floor to ceiling glass doors that open onto a pretty Juliet balcony, flooding the room with natural light and creating a beautiful atmosphere. There is ample dimensions for a cosy lounge area, plenty of room for dining, optional work-from-home space and a well-equipped contemporary kitchen with plenty of storage. The property is ideal for entertaining and would be perfect as a first-time-buy or buy-to-let investment. Adjacent, a generous bedroom with plenty of built-in storage. A family-sized bathroom completes this charming property. The flat further benefits from access to a communal roof terrace, perfect for watching the sun set into the distance in the warmer months.

Features

- One double bedroom
- Close to 500 square feet of well-appointed internal space
- Bright and airy throughout
- Stunning historic period conversion
- Juliet balcony
- Bike storage
- Opposite Brockwell Park
- Communal roof terrace
- Moments from the heart of Herne Hill
- Chain-free

Council tax band C EPC rating (null)



Norwood Road, Herne Hill, SE24

Norwood Road, Tulse Hill, SE24

1 Bedroom Flat

Approximate internal area: 462 sqft 43 sqm

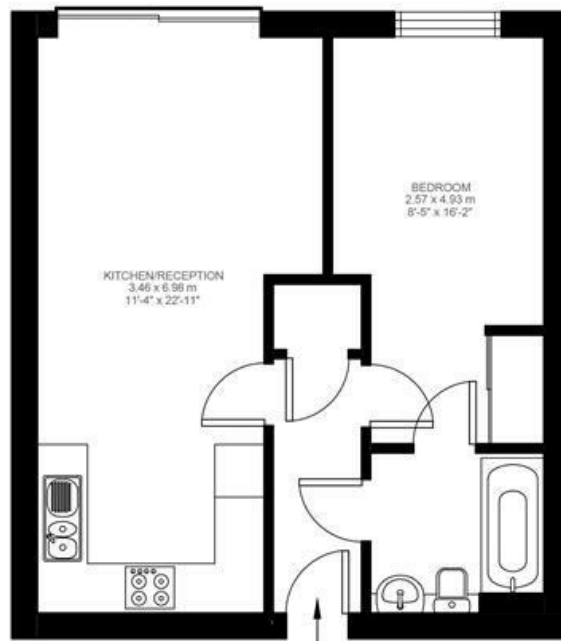

Second Floor



While we do try our very best, floor plans are produced as a guide only and we take no responsibility for the precise accuracy with which any property is represented.

Norwood Road, Herne Hill, SE24

