



Loughborough Park, Brixton, SW9

2 bedroom flat - purpose built for sale

£600,000

Leasehold

Property Details

The heart of the home at the rear of the flat is the spacious 'L' shaped open-plan reception. The space is flooded with natural light through multiple floor-to-ceiling glass windows as well as glass doors opening out onto the private terrace. Ideal for entertaining guests, hosting dinner parties or simply relaxing within the lounge, dimensions allow for comfortable living within a stylish, modern environment. The kitchen opens out onto the living area and is fully equipped with modern, integrated appliances and plenty of storage space. The two bedrooms are generous doubles, the principal bedroom is particularly appealing, complete with built-in storage and a sleek en-suite bathroom. The second bedroom is perfect for anyone sharing with friends, letting the spare room or as a guest room. A further family bathroom and significant hallway storage complete this brilliant second-floor apartment.

Features

- Two double bedrooms
- Two bathrooms
- Private terrace
- Secure modern build
- Bright and airy
- Ideally located between Brixton and Herne Hill
- Within easy reach of Brockwell Park
- Manicured communal grounds
- Extremely energy efficient - EPC B rating

Council tax band D

EPC rating B (85)



Loughborough Park, Brixton, SW9

Lightford House
2 Bedroom Flat

APPROXIMATE TOTAL INTERNAL AREA: 1058 SQ FT / 98.3 SQ M

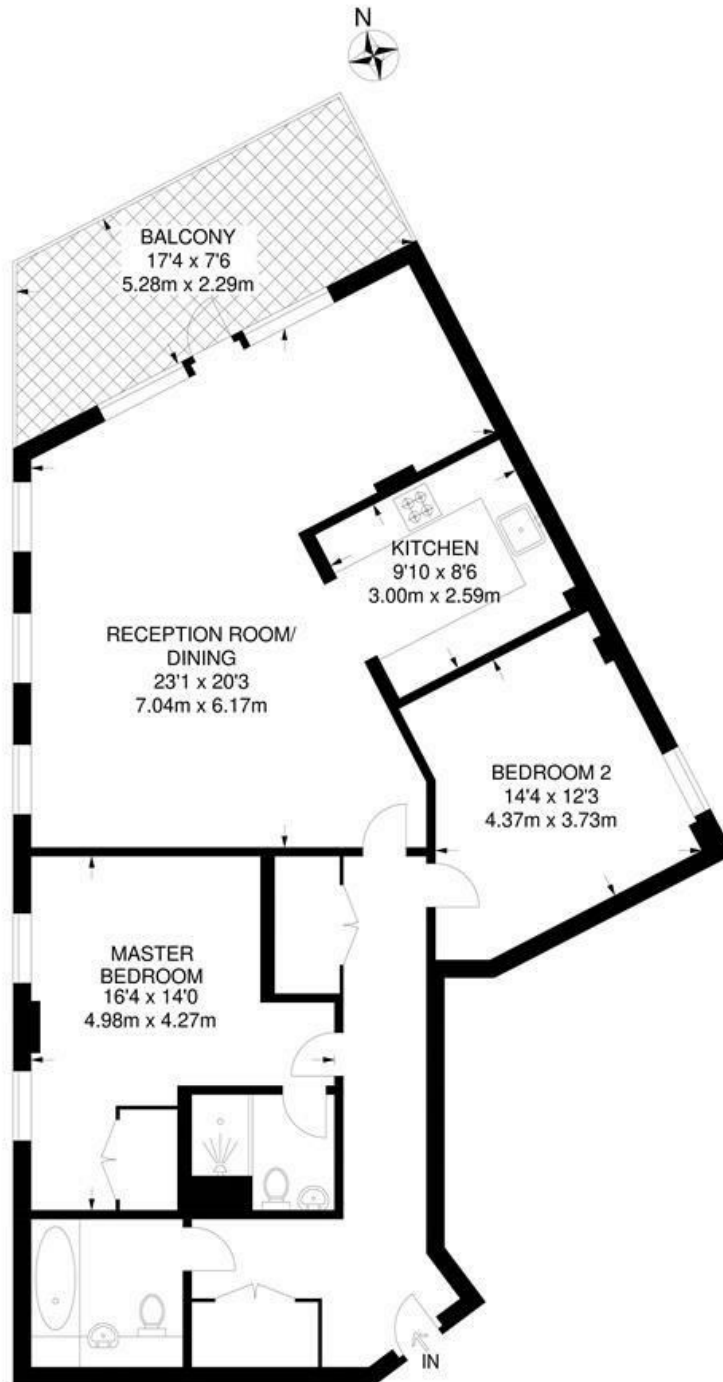

SECOND FLOOR



While we try our very best, floor plans are produced as a guide only and we take no responsibility for the precise accuracy with which any property is represented.

Loughborough Park, Brixton, SW9

